

Just Listed

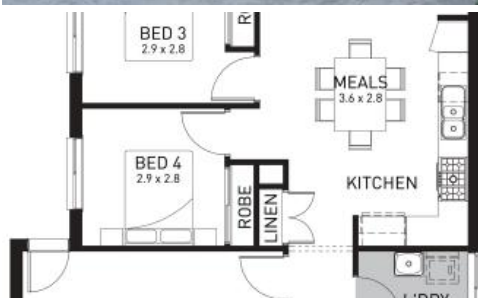

48 Dalmatian Street (Sapphire Estate), Cranbourne East



## Turnkey House & Land Package in Cranbourne East - Titled Lot

### Turnkey Fixed-Price House & Land Package | Titled Land - Ready to Build

Step into a brand-new lifestyle in the heart of Sapphire Estate, Cranbourne East – where family-friendly living meets modern convenience. Close to Shopping on Clyde, Cranbourne Park Shopping Centre, Casey Fields, Schools and Cranbourne Train Station.

Call **Matt** on **0410 692 304** today to secure this dream home.

#### Inclusions

- Fixed Site Costs & Rock Removal
- 900mm Kitchen Appliances
- 20mm Caesarstone Benchtop to Kitchen/Ens/Bath
- Dishwasher
- Tiled Shower Bases
- Floor tiles to Ensuite, Bathroom, Laundry, WC, Kitchen, Meals and Entry, as per plans.
- Carpet to non-tiled areas.
- Block-out Roller Blinds to Windows
- 2 Split Systems to Family Room and Bedroom 1
- Gas ducted heating to Living Areas and Bedrooms

🛏 4 🚿 2 🚗 2 📏 309 m2

Price	\$674,482 Turnkey
Property Type	Residential
Property ID	6768
Land Area	309 m2
Floor Area	174 m2

#### Agent Details

Matthew Bonnett - 0410692304

#### Office Details

Victorian House & Land Specialists  
8 Universal Way Cranbourne West  
VIC 3977 Australia  
03 5995 3911



- Led Downlights to the Main Living Area
- Landscaping To Front & Rear of Property
- Plain Coloured concrete paving to Driveway, Path to Porch, Porch & Outdoor Living.

- Letterbox, Clothesline, Fencing
- Remote Control Garage Door
- Flyscreens and window locks to be installed to all openable window sashes.
- And so much more.... Please contact Matt for the full inclusion list.

---

\*Price and information are subject to change without notice. Land is available at the time this publication was advertised. Kindly enquire with the agent about availability. The price does not include community infrastructure levies imposed or any other fees or disbursements associated with the settlement of the land. Building Construction price is subject to additional design guidelines & travel when applicable. The base price includes a standard brick façade. Images are for illustration purposes only. The house to be constructed.

(POS: Lot 611)

The above information provided has been furnished to us by the vendor/s. We have not verified whether or not that information is accurate and do not have any belief in one way or the other in its accuracy. We do not accept any responsibility to any person for its accuracy and do no more than pass it on. All interested parties should make and rely upon their own inquiries in order to determine whether or not this information is in fact accurate.